

BULK PACK - GT SPORT - P4056



INSTRUCTIONS

DESIGN BLOCK (P4051 only)

Draw car design on all sides of Block. Cut out design with a coping saw (follow manufacturer's safety recommendations). Maintain an even cut by following lines drawn on both sides of Block.

Try *PineCar Racer Shaping Tools (P3930)*.

SAND CAR BODY

Sand car with coarse grade sandpaper to remove rough areas. Next, sand car with medium grade sandpaper, then finish with fine grade to remove sanding marks. Car surface should be equally smooth. Wipe with a clean rag to remove dust.

Try *PineCar Sandpaper Assortment (P380)*.



SEAL AND PAINT

Apply a sanding sealer or primer, per manufacturer's instructions. Next, apply at least two coats of paint. Allow each coat to dry completely and sand lightly with fine grade sandpaper. Apply a final coat of paint, but do not sand. Let dry.

Try *PineCar Sanding Sealer & Wax (P3960)*.



PREPARE AXLES AND WHEELS

To minimize axle friction and increase car speed, polish Axles and tune Wheels before attaching to car. **Axles:** Remove burrs, then polish.

Wheels: Remove parting seams.

Try *PineCar Micro-Polishing System™ (P4038)* and *Wheel Turning Mandrel (P357)*.



ATTACH WEIGHTS

Weigh car before attaching weights. Add maximum amount of weight per official race rules.

PineCar has a complete line of weights.

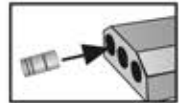

ATTACH WHEELS

Tap Axles and Wheels into grooves. Axles must set flush with bottom of car and Wheels should turn freely.

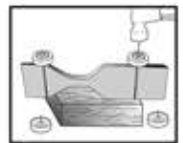

ADD GRAPHITE

Lubricate Axles and Wheels with dry graphite, per official race rules.

Try *PineCar Hob-E-Lube® Dry Graphite (P358)* or *XLR8® Ultra Graphite (P4037)*.



BSA wheels and axles fit this car.

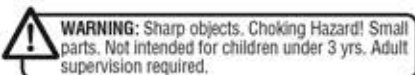

WARNING: Sharp objects. Choking Hazard! Small parts. Not intended for children under 3 yrs. Adult supervision required.



CAUTION: Tools recommended. Use with care.

Made in USA E7 ©2010 O CO

PINECAR® Manufactured by **WOODLAND SCENICS®** PO Box 98, Linn Creek, MO 65052 • pinecar.com